

autoPilot Concept

for PVCu windows



for
windows



Adjustment instructions

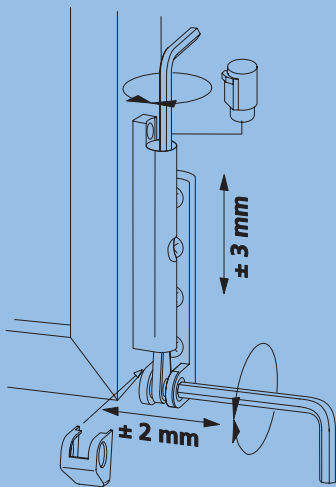

Corner hinge
Height adjustment ($\pm 3 \text{ mm}$) and side adjustment ($\pm 2 \text{ mm}$) of the corner hinge.

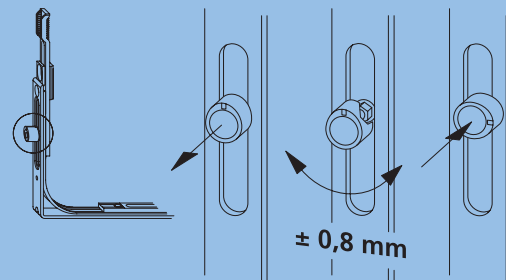

Eccentric cam
Regulation of the installation pressure between the sash and the frame ($\pm 0,8 \text{ mm}$) by pulling up and adjusting the eccentric cam.

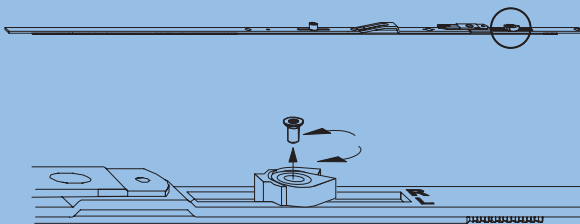

Shear retraction
In middle position: 18 mm. Progresses the shear retraction: 28 mm. Alternatively, a MSL OR SL variable to device can be inserted (see Top rods / shears).

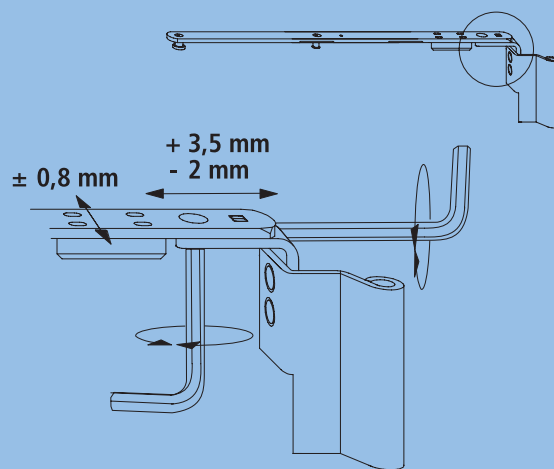

Shear
Adjustment of the closing pressure ($\pm 0,8 \text{ mm}$) and the lifting and the lowering of the sash (from - 2 to + 3,5 mm).

General product information

0
Fitting overviews

1
Drive rods

2
Corner drives

3
Top rods, shears and shear hinges

4
Interlocking rods

5
Shear and corner hinges

6
Accessories

7
Fitting variations

8
Turn only fittings

9
Frame Parts

10
Mounting accessories

11
Mounting instructions

Winkhaus Fenstertechnik GmbH & Co. KG

August-Winkhaus-Straße 31
D-48291 Telgte
T +49 (0) 25 04-921-0
F +49 (0) 25 04-921-340

www.winkhaus.de
fenstertechnik@winkhaus.de